

REFLECTED CEILING PLAN  
SCALE: 3/16"=1'-0"

**REFLECTED CEILING NOTES**

1. ALL GENERAL REFLECTED CEILING NOTES AND INFORMATION INDICATED ON OTHER DRAWINGS, INCLUDING BUT NOT LIMITED TO DRAWINGS C-1 & C-2, APPLY TO THE REFLECTED CEILING PLANS.
2. MECHANICAL, ELECTRICAL, AND PLUMBING SYSTEMS SHALL BE DESIGNED AND INSTALLED SO AS TO AVOID THE NEED FOR ACCESS ABOVE ANY GYPSUM BOARD OR NON-ACCESSIBLE CEILING.
3. ALL FLUORESCENT LIGHTING TO HAVE ENERGY EFFICIENT ELECTRONIC BALLASTS APPROVED BY THE LOCAL UTILITY COMPANY. ALL FLUORESCENT LIGHT BULBS TO BE AS NOTED ON MEP ENGINEERING DRAWINGS. THIS INCLUDES ALL TASK LIGHT AND UNDERCOUNTER LIGHT BULBS. THE CONTRACTOR IS TO REPLACE BULBS ON PRELAMPED OR EXISTING FIXTURES AS REQUIRED TO MEET THE ABOVE REQUIREMENTS.
4. IF THERE ARE ANY CONFLICTS BETWEEN ELECTRICAL AND ARCHITECTURAL PLANS, THE CONTRACTOR SHALL PRICE FOR THE GREATER QUANTITY. FOR ANY ITEM SHOWN IT SHALL MEAN TO FURNISH AND INSTALL THAT PARTICULAR ITEM.
5. THERMOSTATS ARE TO BE LOCATED AT 48" A.F.F.
6. TRANSFER OPENINGS FOR RETURN AIR SHALL BE LOCATED ABOVE DOORWAYS IN CEILING PLENUM. THE OPENINGS SHALL BE SAW CUT FROM CEILING SLAB DOWN.
7. WRITTEN, COMPREHENSIBLE INSTRUCTIONS CONCERNING THE OPERATION OF AIR CONDITIONING UNITS, THERMOSTATS, TIMERS, AND OTHER SYSTEMS SHALL BE PROVIDED TO THE ARCHITECT AND OWNER/CLIENT UPON COMPLETION OF THE PROJECT.
8. ALL SHOP DRAWINGS, INCLUDING THOSE FOR MECHANICAL, ELECTRICAL AND PLUMBING SYSTEMS SHALL BE ROUTED THROUGH THE ARCHITECT. CONSTRUCTION IS NOT AUTHORIZED UNLESS DRAWINGS HAVE BEEN REVIEWED BY THE ARCHITECT.
9. THE GENERAL CONTRACTOR IS RESPONSIBLE FOR ALL LIGHT BULBS UNTIL THE COMPLETION OF THE PUNCHLIST IN AREAS OF PROPOSED WORK.
10. THE GENERAL CONTRACTOR SHALL PROVIDE (2) UNOPENED BOXES OF EACH TYPE OF CEILING TILES TO THE TENANT/LANDLORD UPON COMPLETION OF THE PROJECT.
11. ALL REQUIRED ACCESS LOCATIONS ABOVE SUSPENDED CEILING MUST BE CLEARLY TAGGED. ANY ACCESS DOOR LOCATIONS IN CEILING OR WALLS MUST BE CONFIRMED WITH THE ARCHITECT PRIOR TO INSTALLATION.
12. THE CONTRACTOR WILL BE RESPONSIBLE FOR DETERMINING QUANTITY OF ACCESS DOORS BASED ON THE CONTRACT DOCUMENTS. ADDITIONAL CHARGES FOR ACCESS DOORS WILL NOT BE ACCEPTED. ALL ACCESS DOORS WILL BE OF HIGH QUALITY AND FLUSH TYPE.
13. ALL LOW VOLTAGE CABLES ARE TO BE LEVEL 5 (OR AS DIRECTED BY ENGINEERING DRAWING) AND PLENUM RATED UNLESS INDICATED OTHERWISE BY CLIENT.
14. CONTRACTOR TO PROVIDE 3/8" TRANSITION REVEAL MOLDING WHERE EVER SUSPENDED ACOUSTICAL CEILING TILE AND GYPSUM BOARD CEILING MEET AT THE SAME HEIGHT.
15. ALL CENTERLINE OF SWITCHES (LIGHTING OR OTHERWISE) TO BE LOCATED AT 4'-0" A.F.F OR MATCH BUILDING STANDARD.
16. THE GENERAL CONTRACTOR WILL COORDINATE HVAC, PLUMBING AND ELECTRICAL INSTALLATION TO PREVENT INTERFERENCE WITH PROPER COMPLETION OF CONSTRUCTION OR INSTALLATION OF CEILING AND/OR LIGHTING FIXTURES AS SHOWN ON PLAN. ANY CONFLICTS WILL BE BROUGHT TO THE ARCHITECTS ATTENTION FOR RESOLUTION PRIOR TO FABRICATION OR INSTALLATION.
17. CONTRACTOR IS TO INSPECT ALL EXISTING DUCTWORK REMAINING WHICH PENETRATES FIRE RATED PARTITIONS. FIRE DAMPERS AND SMOKE DAMPERS ARE TO BE INSTALLED IN ALL DUCTS AT FIRE RATED OPENINGS WHICH DO NOT CURRENTLY HAVE THEM.
18. UNDERCABINET LIGHTS TO BE A MAXIMUM 120 VOLTS.
19. ALL RETURN AIR GRILLES TO MATCH SUPPLY DIFFUSERS.
20. REFER TO THE MECH./ELEC. DRAWINGS OR SUBMITTALS FOR LOCATIONS TO SUPPLY & RETURN DIFFUSERS AS WELL AS SPRINKLER HEAD LOCATIONS.
21. THE GENERAL CONTRACTOR IS RESPONSIBLE FOR REPAIRING ANY DAMAGE TO EXISTING BUILDING AS A RESULT OF THE CONSTRUCTION OF THE SPACE.
22. DO NOT SCALE DRAWINGS. IF DIMENSIONS ARE IN QUESTION, THE CONTRACTOR SHALL BE RESPONSIBLE FOR OBTAINING CLARIFICATION FROM THE ARCHITECT BEFORE CONTINUING WITH CONSTRUCTION.
23. THE GENERAL CONTRACTOR SHALL VERIFY ON SITE ALL DIMENSIONS AND EQUIPMENT LOCATIONS, INCLUDING EQUIPMENT SUPPLIED AND INSTALLED BY OTHERS PRIOR TO CONSTRUCTION.
24. CONDITIONS INDICATED ON THE DRAWINGS ARE WHAT COULD BE DETERMINED FROM A VISUAL OBSERVATION. ACTUAL CONDITIONS MAY VARY. GENERAL CONTRACTOR SHALL INSPECT EXISTING CONDITIONS UPON DEMOLITION/CONSTRUCTION TO DETERMINE ACTUAL CONDITIONS. IF AFTER SUCH EXAMINATION THE CONDITIONS DO VARY FROM THE DRAWINGS, THE GENERAL CONTRACTOR SHALL NOTIFY THE ARCHITECT IMMEDIATELY OR TAKE RESPONSIBILITY FOR THEIR ACTIONS.
25. THE ARCHITECT HAS NOT BEEN RETAINED FOR DESIGN OR MODIFICATION OF THE ELECTRICAL, HEATING, AIR CONDITIONING, VENTILATION, PLUMBING OR SPRINKLER SYSTEMS. REFER TO MEP ENGINEERING DRAWINGS FOR THIS INFORMATION.
26. CONTRACTOR TO SUPPLY AND INSTALL A MINIMUM OF 2 SEISMIC SUSPENSION WIRES ANCHORED TO DECK OR STRUCTURE ABOVE AT EACH LIGHT FIXTURE LOCATION.

**REFLECTED CEILING LEGEND**

- NEW HUNG CEILING CLASS A, 2' X 2' X 5/8" WHITE DUNE ANGLED TEGULAR TILE # 1774-- BY ARMSTRONG OR EQUAL CEILING GRID SHOULD BE INTERMEDIATE DUTY, DIRECT HUNG, MATTE WHITE FINISH 24" X 24" GRID, WITH ALL REQUIRED TRIMS AND ACCESSORIES FOR CONDITIONS IN THE FIELD, BY ARMSTRONG, PRELUDE SERIES, PRELUDE XL 15/16" EXPOSED TEE.
- 2' X 4' LAY-IN TROFFER, 3" DEEP PARABOLIC LOUVER, T-8 ELECTRONIC BALLAST LAMPS: T-8 3500° K, 32WTS
- 2' X 4' LAY-IN TROFFER, 3" DEEP PARABOLIC LOUVER, T-8 ELECTRONIC BALLAST, NIGHT LIGHT LAMPS: T-8 3500° K, 32WTS
- 2' X 4' PRISMATIC LIGHT FIXTURE T-8 ELECTRONIC BALLAST LAMPS: T-8 3500° K, 32WTS
- NEW SINGLE POLE SWITCH
- NEW DIMMER SWITCH
- NEW THREE WAY SWITCH
- PENDANT LIGHT FIXTURE
- WALL WASHER LIGHT FIXTURE
- RECESSED LIGHT FIXTURE
- EXHAUST FAN
- DECORATIVE WALL SCONCE LIGHT FIXTURE
- NEW WALL PACK EMERGENCY LIGHT
- NEW WALL MOUNT ILLUMINATED EXIT SIGN WITH BATTERY PACK
- NEW CEILING MOUNT ILLUMINATED EXIT SIGN
- NEW UNDER CABINET LIGHTING (REFER TO ENGINEER'S DWG)

NOTE: FOR ADDITIONAL SYMBOLS, REFER TO DRAWING C-1.

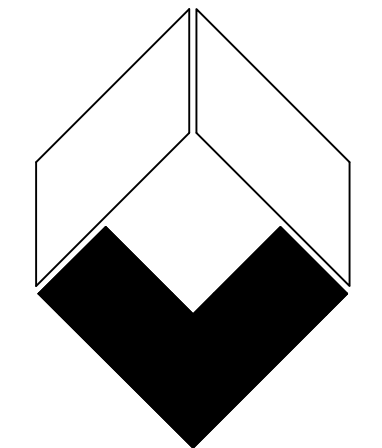

**a. paul Varanouskas > architect**

architecture  
planning  
interior design

46 foster road - suite 1  
hopewell jct. ny 12533  
t 845-223-1009  
f 845-223-1909

All ideas, designs, plans & specifications indicated or represented by this drawing are by, and are the property of A. Paul Varanouskas, Architect. Any unauthorized use of these drawings or parts thereof without the written permission of the architect, shall be prosecuted.

Rev.	Date	Remarks

**KEY PLAN NOT TO SCALE**

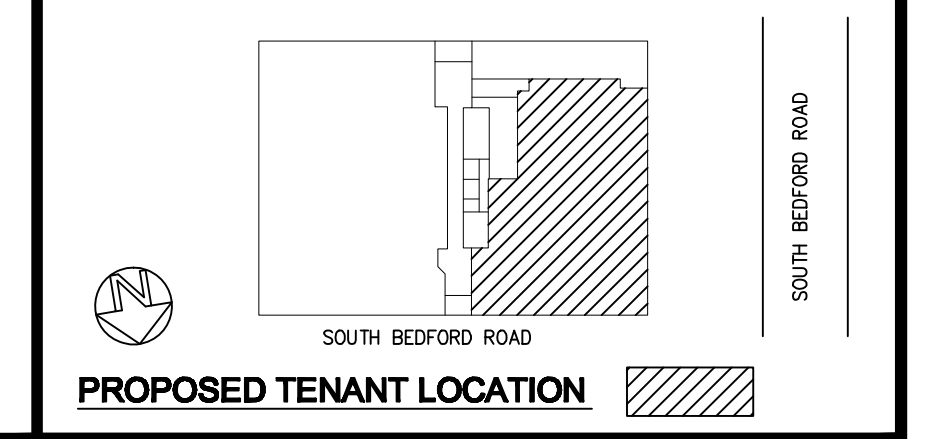

**Proposed Alterations For  
Ophthalmology Department  
at  
90 South Bedford Road  
Mount Kisco, NY 10549**

Date: 01-11-10	Project No: 09055
Drawn By: GPL	Scale: AS NOTED

**REFLECTED CEILING PLAN**

Seal

Drawing No:  
**A - 2**